

Current part is item (9) on diagram. Available at [www.oshkoshequipment.com](http://www.oshkoshequipment.com)

(1)	(2)	(3)	(4)	(5)	(6)				(7)			(8)			(9)	(10)	
SMR	FEDERAL	DESCRIPTION	UNIT	QTY	15-DAY ORGANIZATION				30-DAY DS			30-DAY GS			1-YR. ALW	ILLUSTRATION	
CODE	STOCK		OF	INC	MAINTENANCE				MAINTENANCE			MAINTENANCE			PER 100	(A)	(B)
	NUMBER		MEAS	IN	ALLOWANCE				ALLOWANCE			ALLOWANCE			EQUIP	(A)	(B)
		REFERENCE NUMBER & MFR CODE	USABLE ON CODE	UNIT	(A)	(B)	(C)	(D)	(A)	(B)	(C)	(A)	(B)	(C)	PLANNING	FIG	ITEM
					1-5	6-20	21-50	51-100	1-20	21-50	51-100	1-20	21-50	51-100		NO	NO
PAOZZ	5306-797-9338	BOLT, MACH, HEX HD: 7/8-14NF-3 X 101/4 7979338 (19207)		EA	24	*	*	*	*	*	*	*	*	*		37	4
PAOZZ	2510-734-6998	BRACKET ASSY: SPRING GUIDE 7979363 (19207)		EA	4	*	*	*	*	*	*	*	*	*		37	5
XAOZZ		BRACKET: SPRING GUIDE 7979364 (19207)		EA	4											37	6
PAOZZ	2510-734-6999	PLATE: SPRING GUIDE 7346999 (19207)		EA	4	*	*	*	*	*	*	*	*	*		37	7
XAOZZ		RIVET: 3/8 X 1 3/8, COUNTERSUNK HD MS357744-70 (96906)		EA	8											37	8
PAOZZ	2510-734-6952	PLATE, SPRING BRG 7979272 (19207)		EA	4	*	*	*	*	*	*	*	*	*		37	9
PAOZZ	5310-754-2005	WASHER, LOCK, SPLIT: 7/8 ID MS35338-52 (96906)		EA	24	*	*	*	*	*	*	*	*	*		37	10
PAOZZ	5310-734-6957	NUT, PLAIN, HEX: 7/8-14NF-3 7979327 (19207)		EA	24	*	*	*	*	*	*	*	*	*		37	11
PAOZZ	2530-797-9224	BRACKET: TORQUE ROD 7346955 (19207)		EA	6	*	*	*	*	*	*	*	*	*		37	12
PAOZZ	2530-797-9311	BRACKET: UPPER TORQUE ROD BRACKET MIG 7979311 (19207)		EA	2	*	*	*	*	*	*	*	*	*		37	13
PAOZZ	5310-842-7634	NUT, SLOTTED, HEX: 1 1/2-12NF-3 MS35692-109 (96906)		EA	12	*	*	*	*	*	*	*	*	*		37	14
PAOZZ	5315-187-9567	PIN, COTTER: 3/16 X 2 1/2 MS24665-500 (96906)		EA	12	*	*	*	*	*	*	*	*	*		37	15
		GROUP 18-BODY															
XBOZZ		1808-STOWAGE BOX BOX ASSY, STOWAGE 8730451 (19207)	D, E	EA	1											38	
XBOZZ		BOX, STOWAGE: WELDED 87304737 (19207)		EA	1											38	1
PAOZZ	5310-732-0558	NUT, PLAIN, HEX: 3/8-16 UNC-2B (DOOR MTG) MS51967-8 (96906)		EA	16	*	*	*	*	*	*	*	*	*		38	2
PAOZZ	5310-637-9541	WASHER, LOCK, SPLIT: 3/8 ID (DOOR MTG) MS35338-46 (96906)		EA	16	*	*	*	*	*	*	*	*	*		38	3
PAOZZ	5305-269-3211	SCREW, CAP, HEX HD: 3/8-16 UNC-2A X 1/8 (DOOR MTG) MS90725-60 (96906)		EA	16	*	*	*	*	*	*	*	*	*		38	4
PAOZZ	2510-177-7807	DOOR ASSY: W/SEALS 8730443 (19207)		EA	2	*	*	*	*	*	*	*	*	*		38	5
XAOZZ		SEAL: SYN RU, 101/8 X 3/4 X 1/2 8730449 (19207)		EA	4											38	6

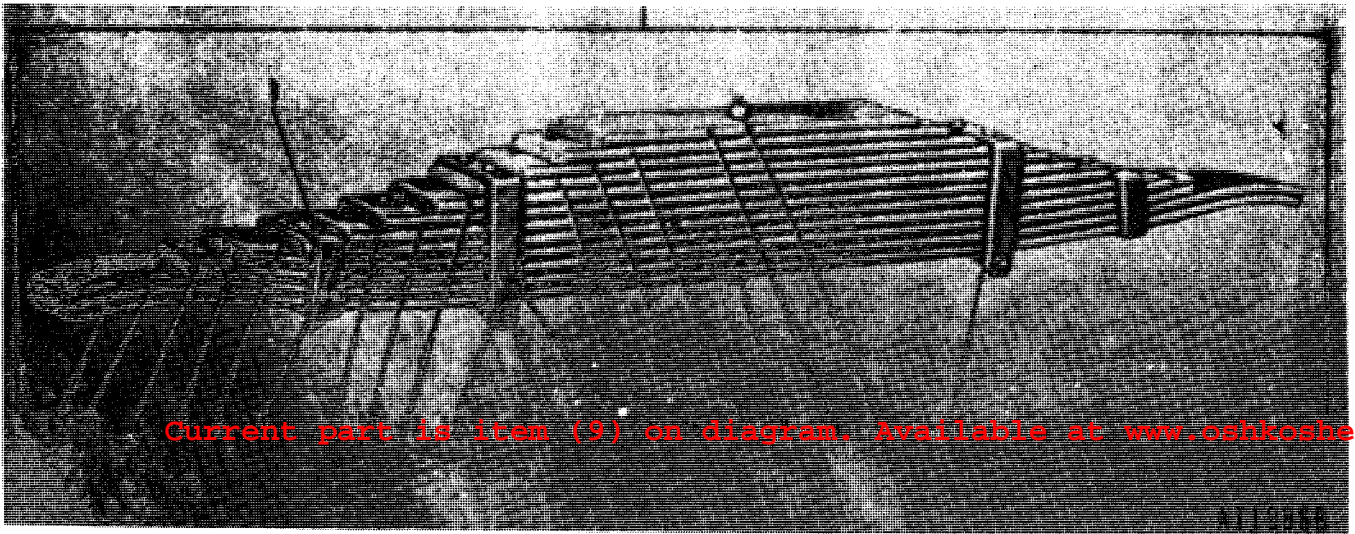

Current part is item (9) on diagram. Available at [www.oshkoshequipment.com](http://www.oshkoshequipment.com)



Current part is item (9) on diagram. Available at [www.oshkoshequi](http://www.oshkoshequi)

Figure 36. Spring assembly (7979217)—assembled view.

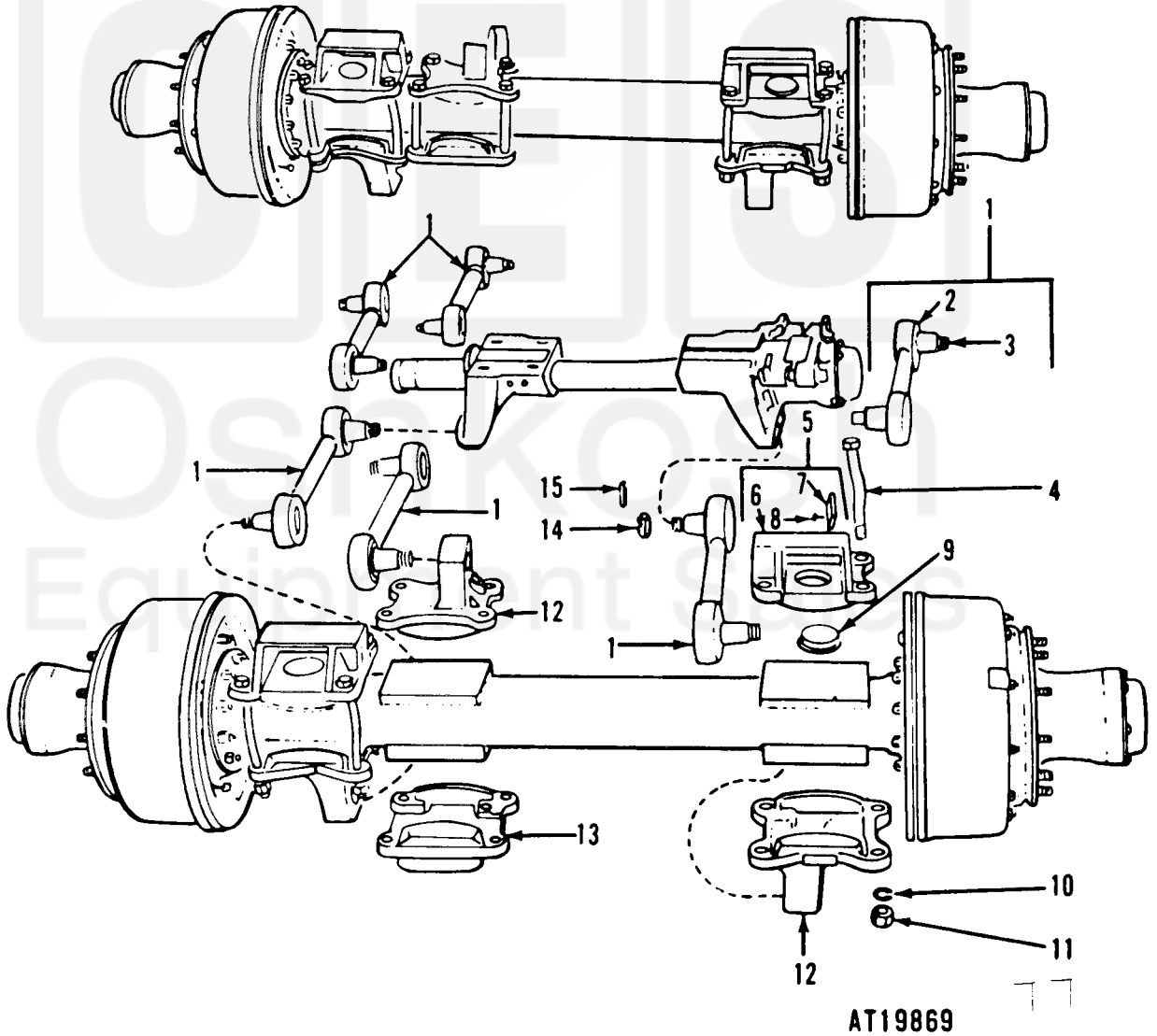

AT19869

Figure 37. Torque rods, spring guide brackets, and attaching parts—exploded view.

Current part is item (9) on diagram. Available at [www.oshkoshequi](http://www.oshkoshequi)